

FORMAX[®]

Square iT2
Squareback Booklet Finisher

1 Unpack and Installation Instruction

1.1	Unpacking Instruction.....	1-2
1.2	Installation Precautions.....	1-7
1.3	Installation Requirements.....	1-8
1.3.1	Minimum Space Requirements.....	1-8
1.3.2	Power Requirements.....	1-8
1.4	Squareback Booklet Trimmer Installation.....	1-9
1.4.1	Accessory Check.....	1-9
1.4.2	Tilt Protection Installation.....	1-10
1.4.3	Feed Tray Installation.....	1-11
1.4.4	Trimmer security screws.....	1-12
1.4.5	Belt Stacker Installation.....	1-17
1.4.6	Caster Locking Position.....	1-18
1.4.7	Earth Bonding.....	1-18
1.4.8	Plugging in the Machine.....	1-18

1.1 Unpacking Instruction

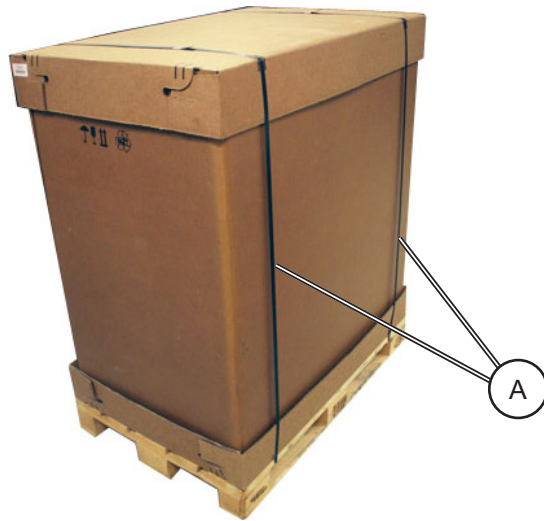

1. Remove the straps [A].

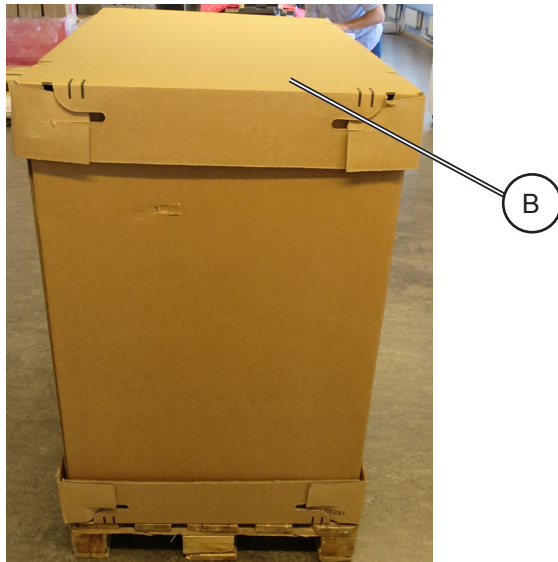

2. Remove the lid [B].

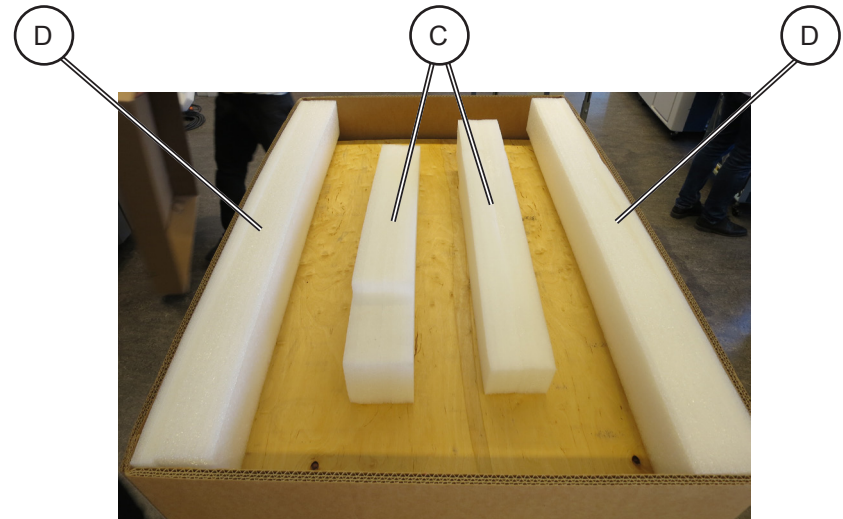

3. Remove Ramp supports [C] (2x) and save them.

4. Remove protective foam [D].



5. Remove ramp [E] and save it.

1.1 Unpacking Instruction (continued)

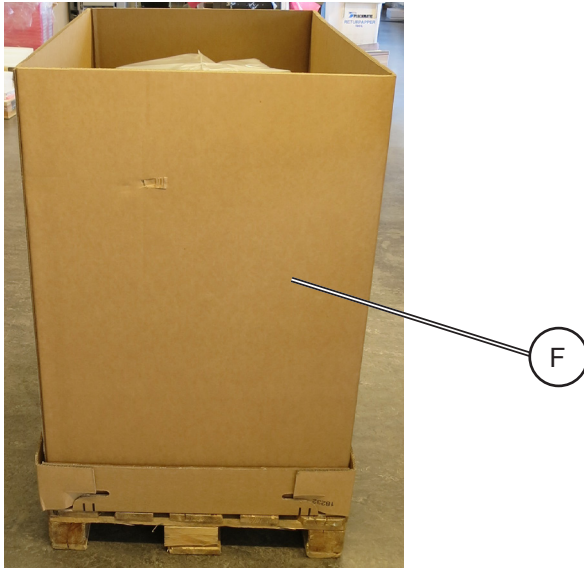

6. Remove Paper Box [F].



7. Remove protective plastic [G] and insert ramp supports [H].

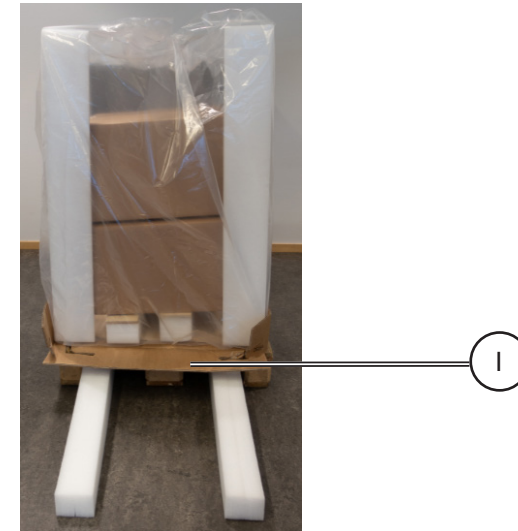

8. Fold cardboard down [I].

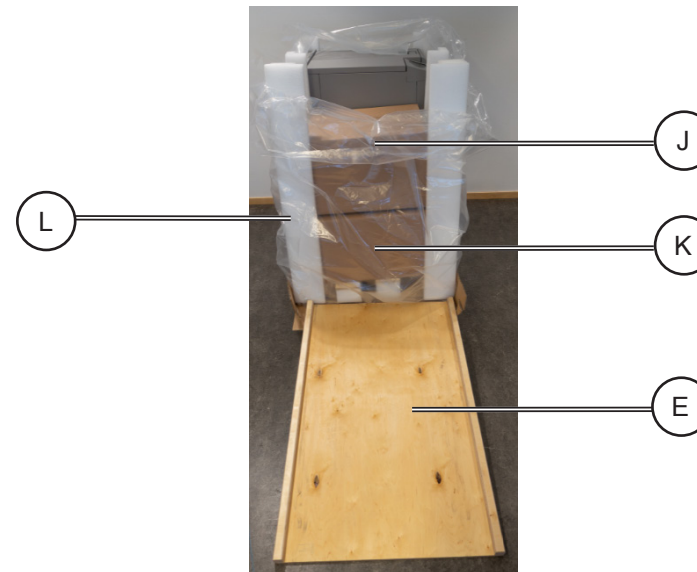

9. Remove boxes [J] Stacker, [K] HandFeed Table/Support Leg and foam [L]. Lay ramp [E] in position.

1.1 Unpacking Instruction (continued)

⚠ WARNING:
Two people
are required
to remove
support
foams.



10. Remove Foam Support [S].

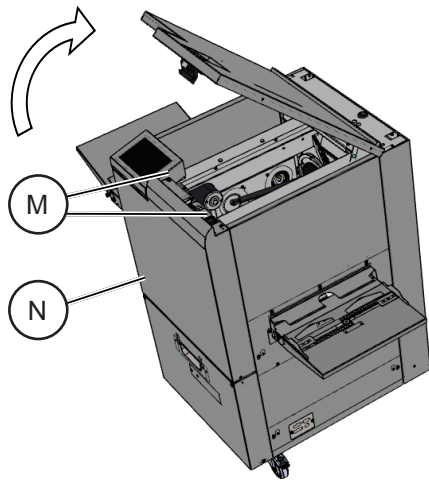

11. Open the top cover on the Main Module to get access to screws [M] (2x) and remove them.
12. Lift the front cover [N] up and pull it outwards to remove it.

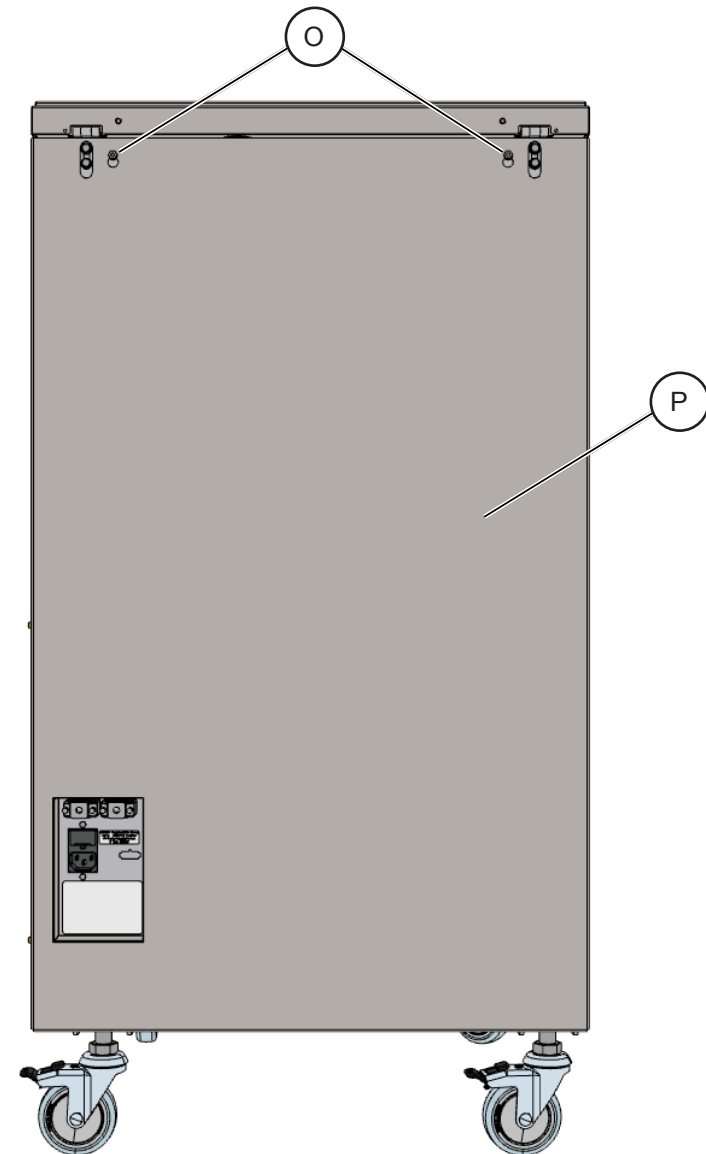

13. Loosen screws [O] (2x).
14. Lift rear cover [P] up and pull it outwards to remove it.

1.1 Unpacking Instruction (continued)

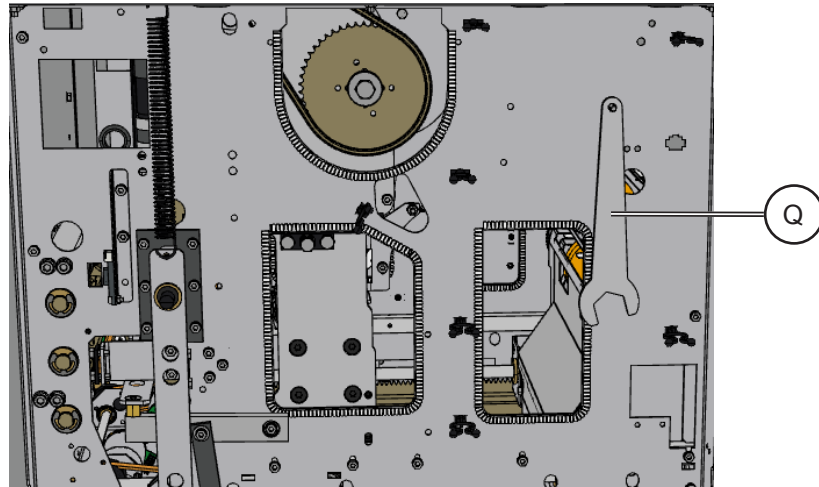

15. Spanner [Q] to adjust Caster height is located under front cover.

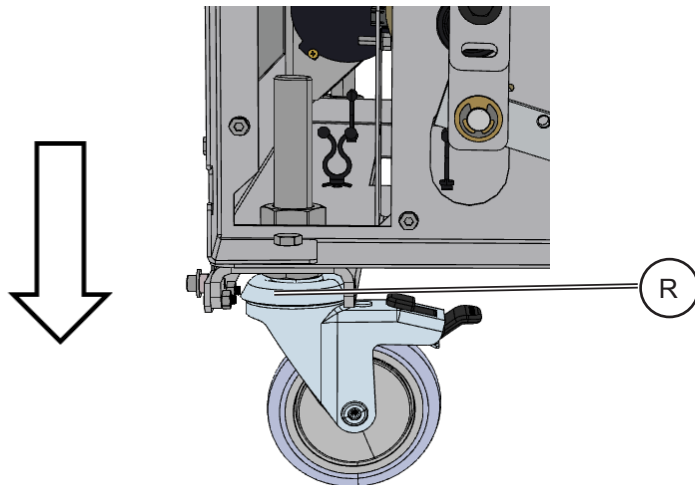

16. Move Casters [R] down.

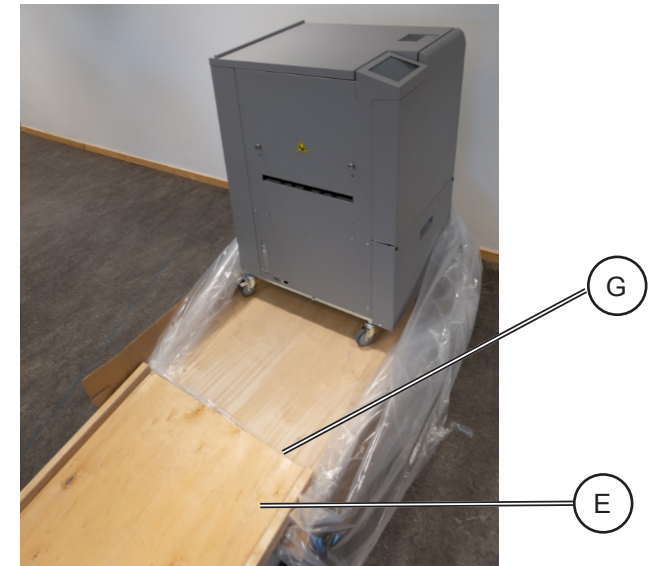

17. Place ramp [E] on top of Plastic [G].

18. If not performing installation at the same time as unpacking, replace front and rear cover.

1.1 Unpacking Instruction (continued)



19. Move machine down Ramp.

⚠ WARNING:
Two people are required to roll the machine down the ramp.

Intentionally blank.

1.2 Installation Precautions

⚠ CAUTION:

ESD Hazard! ESD (Electrostatic Discharge) can cause hardware crashes, data and/or communications problems. Failure to use proper ESD procedures will cause damage to electronic components (example: PCBs). ESD problems can be minimized by maintaining all machine ground connections, ensuring the proper handling of circuit boards/ sensors.

Use ESD protection when working near PCBs. Failure to use ESD protection is likely to result in a PCB failure.

⚠ WARNING:

If installation/s to be performed are additions to an existing, already installed system, turn off the Main Power Switch/es and disconnect the Main Power Cord/s before disconnecting, removing or replacing any electrical components. Do not connect power cord/s unless instructed.

⚠ WARNING:

To avoid hazardous situations like for instance electric shock or danger while exposed to moving, rotating or cutting devices, exercise extreme care when operating modules with covers, guards or protection removed or when electrical or mechanical interlock devices are overridden or bypassed.

Notice: This machine has been designed and certified for connection to IT power distribution systems according to UL 60950-1, 2nd Edition.

Intentionally blank.

1.3 Installation Requirements

1.3.1 Minimum Space Requirements

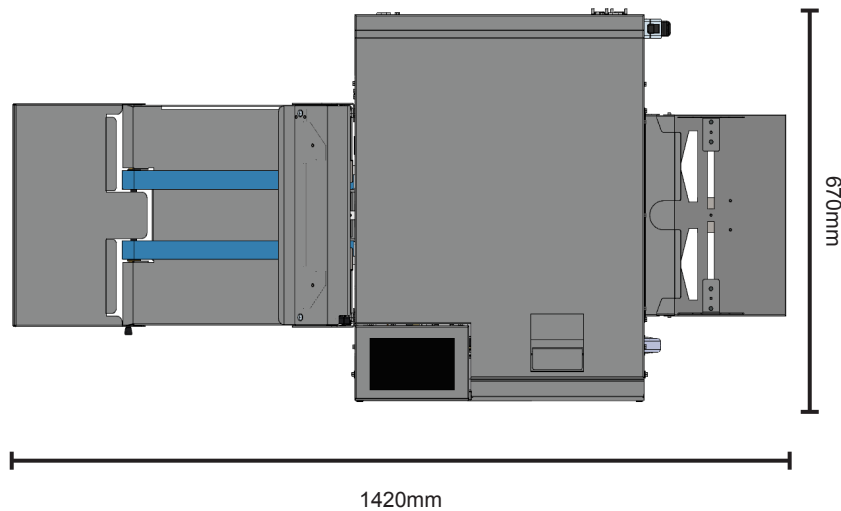

1.3.2 Power Requirements



WARNING

1. Make sure that the wall outlet is near the main machine and easily accessible. Make sure the plug is firmly inserted in the outlet.
2. Avoid multi-wiring.
3. Be sure to ground the machine.
4. Never place anything on the power cord.

- Universal Power Supply
- 100-240V +6%/-10%, 50-60 Hz

1.4 SquareFold Trimmer Installation

1.4.1 Accessory Check

Item	Qty	Description
1	1	Power cord EUR/IEC 1.0mm ² 80mm
2	1	Power cord USA/IEC AWG-14 80mm
3	1	Power cord UK/IEC 1.0mm ² 80mm
4	1	Power cord AUS/IEC 1.0mm ² 80mm
5	1	Power cord Swiss/IEC 1.0mm ² 80mm
6	1	Power cord Denmark IEC 1.0mm ² 80mm
7	1	Extension cord 420mm
8	1	Tilt Protection
9	1	Feed Tray

For part number information, see Parts Catalog.

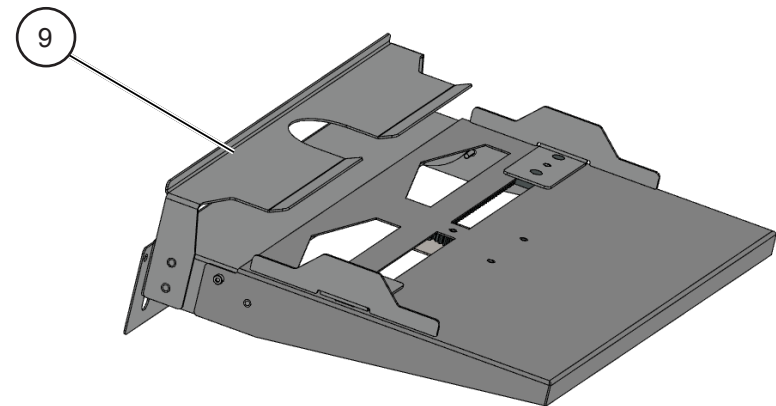
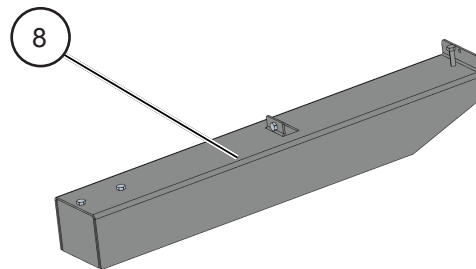
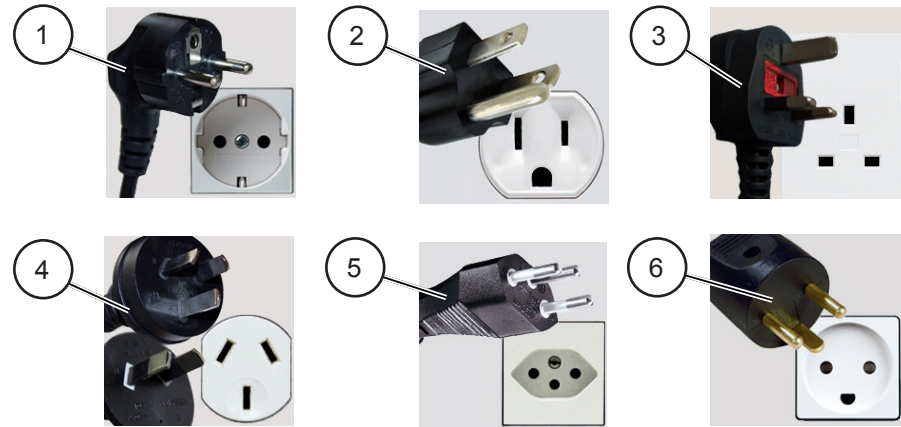

1.4.2 Tilt Protection Installation

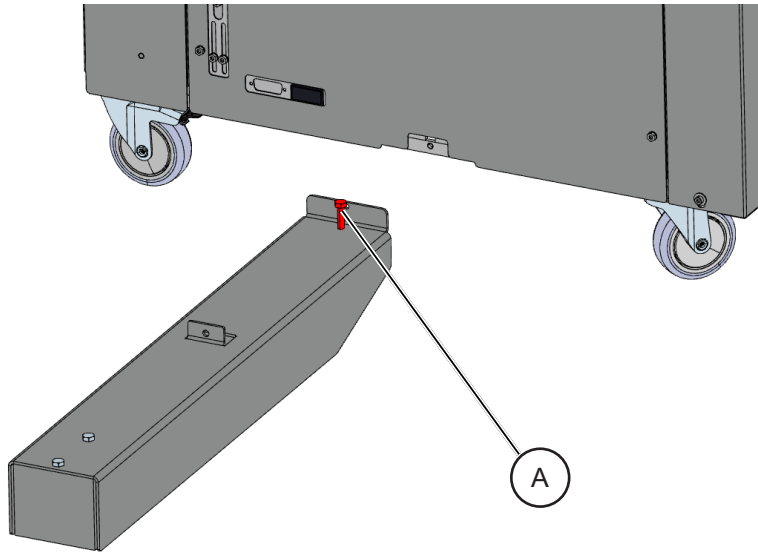

1. Align Tilt Protection Stud [A] with centre of Main Module.

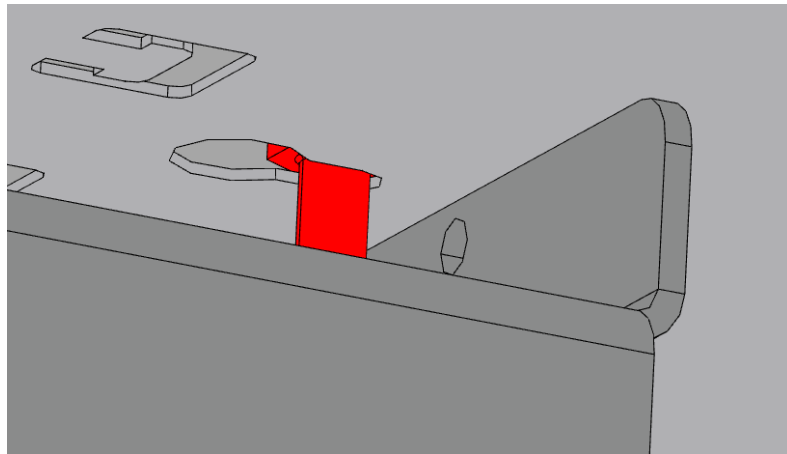

2. Insert Tilt Protection Stud into Base of Main Module.

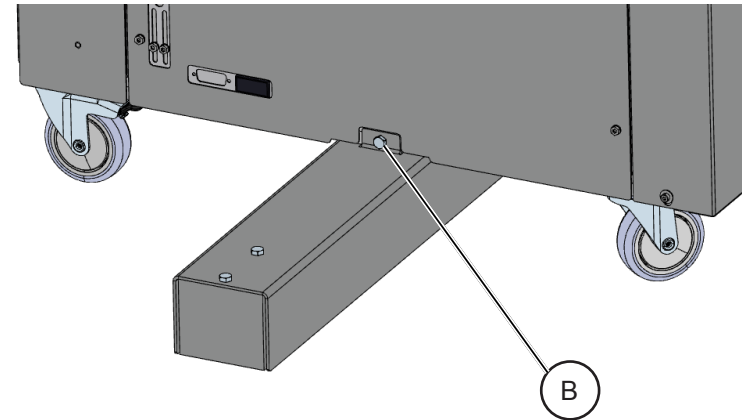

3. Secure Tilt Protection with centre of Main Module using retaining screw [B].

1.4.3 Feed Tray Installation

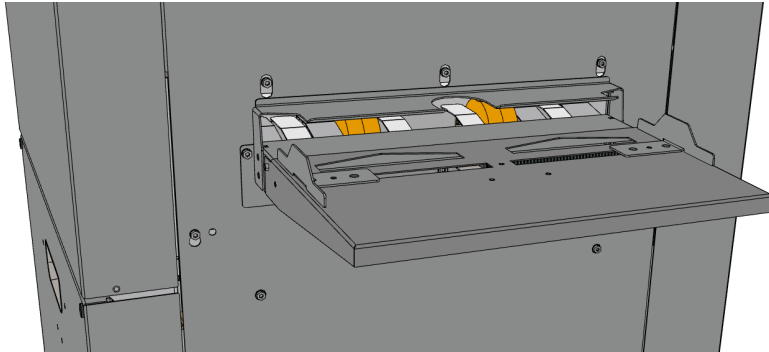

1. Align Manual Feed Tray to opening.

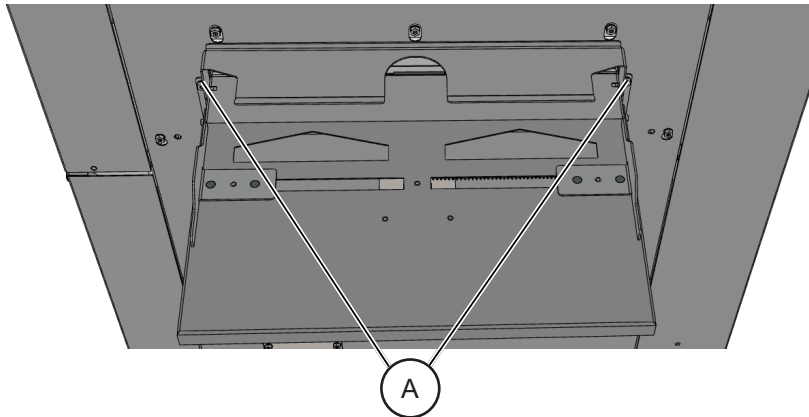

2. Secure the Manual Feed Tray with two screws [A].

Intentionally blank.

1.4.4 Trimmer security screws

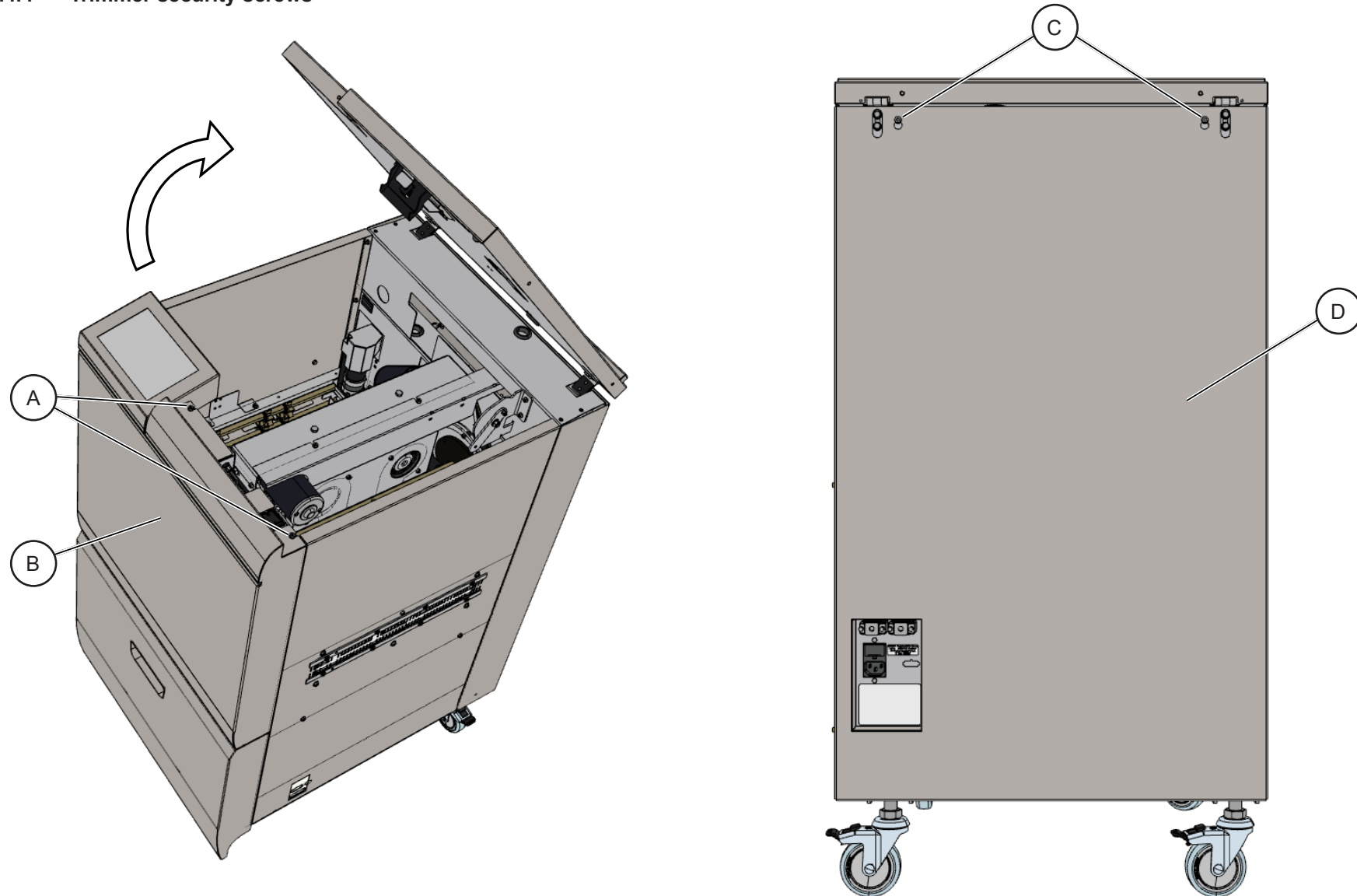

1. Open the top cover on the Main Module to get access to screws [A] (2x) and remove them.
2. Lift the front cover [B] up and pull it outwards to remove it.

3. Loosen screws [C] (2x).
4. Lift rear cover [D] up and pull it outwards to remove it.

1.4.4 Trimmer security screws (continued)

The Square iT2 is shipped with two security screws and a security axis installed through the Trim Module to prevent it from moving during shipment. These three items need to be removed before starting the machine. Failure to do so will damage the machine, as it will start to initialize as soon as it is turned on. Follow the procedure for how to remove these items in the next pages.

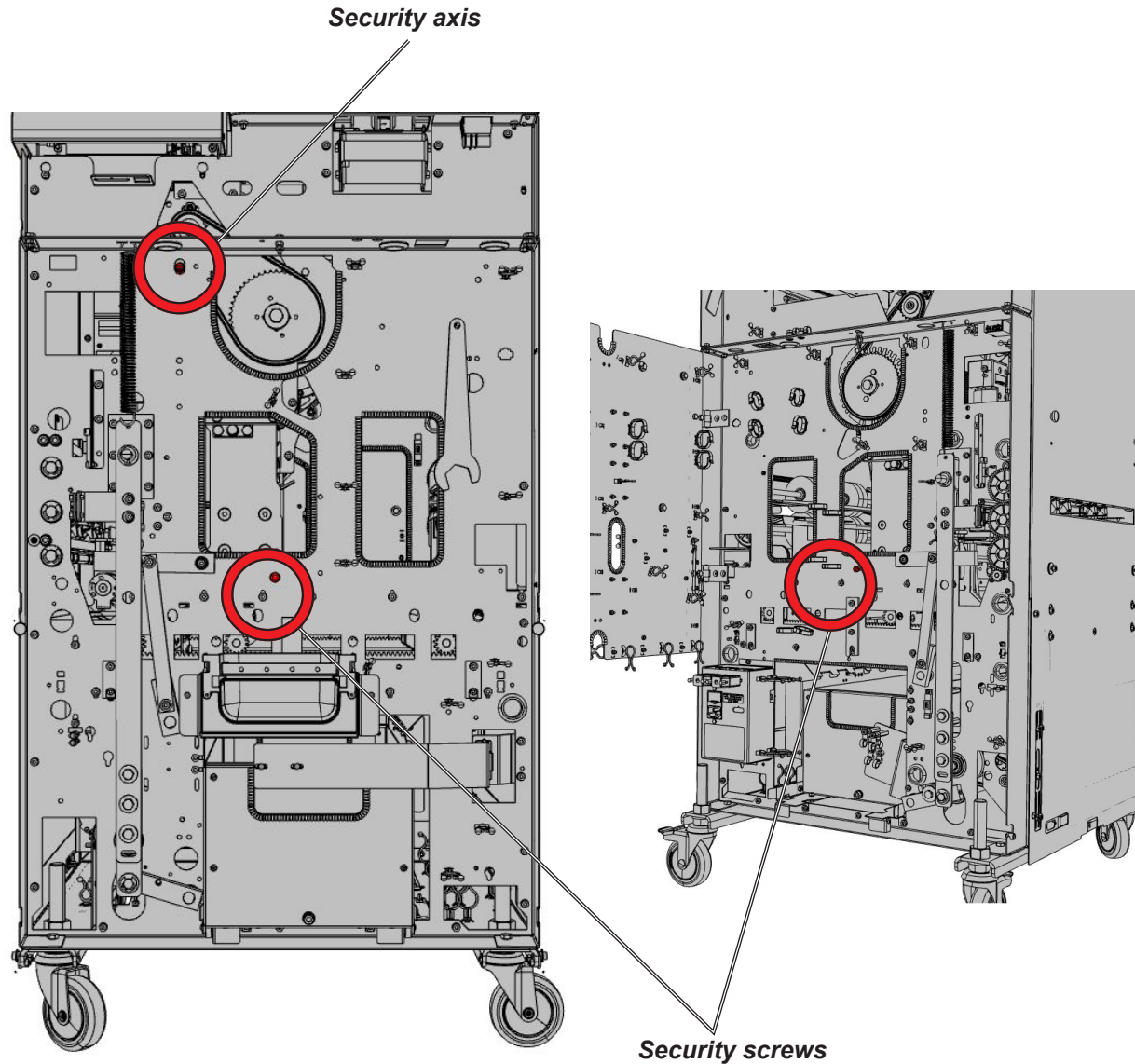

1.4.4 Trimmer security screws (continued)

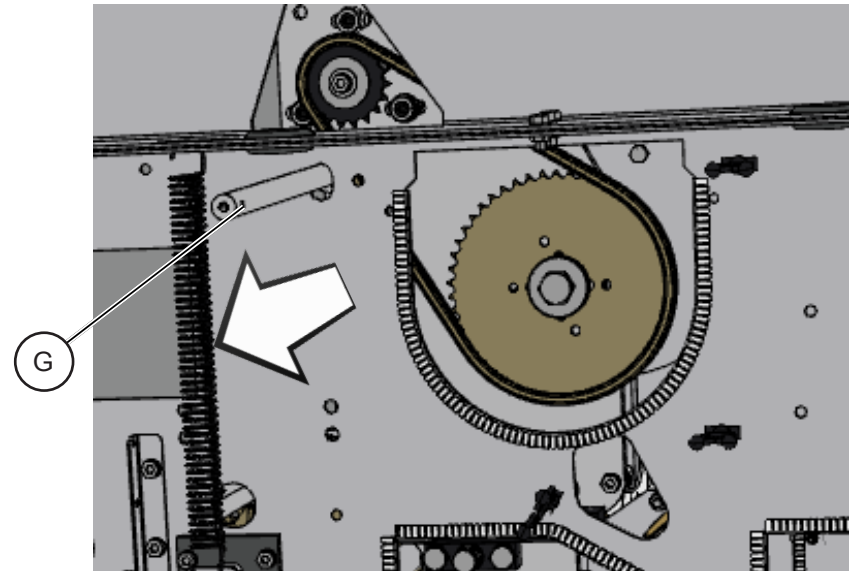
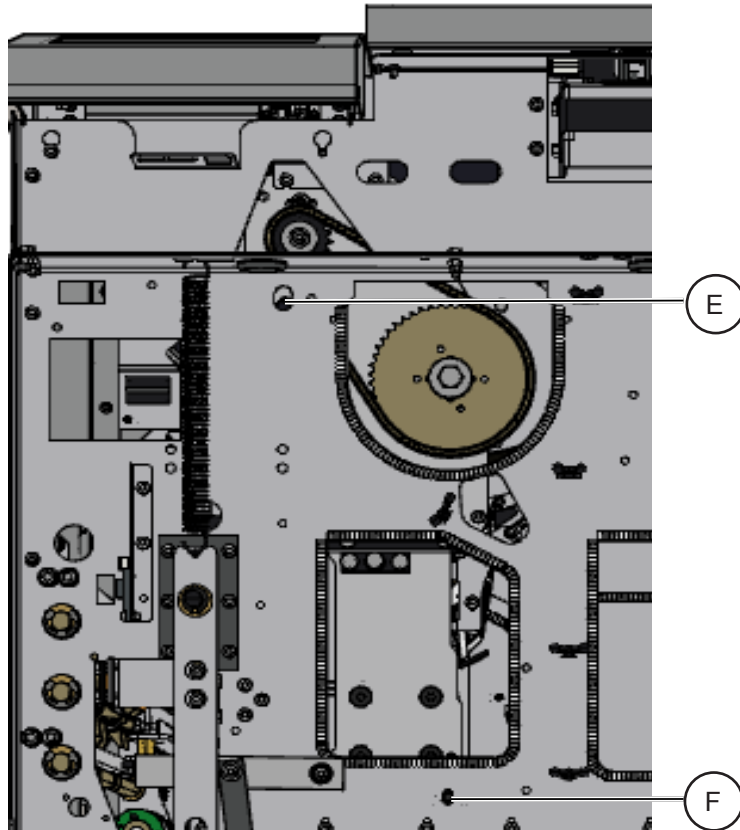

5. Loosen screw [E] and remove screw [F] in the front of the machine.
(Screw [F] needs to be stored. It might be needed in the future to ship the module again).

6. Remove Axis [G].

⚠ CAUTION:

It is crucial to remove these screws and axis, otherwise, once the power is switched on, the machine will start to initialize and will damage the trimmer module

1.4.4 Trimmer security screws (continued)

7. Move Axis [G] from position [1] to position [2].

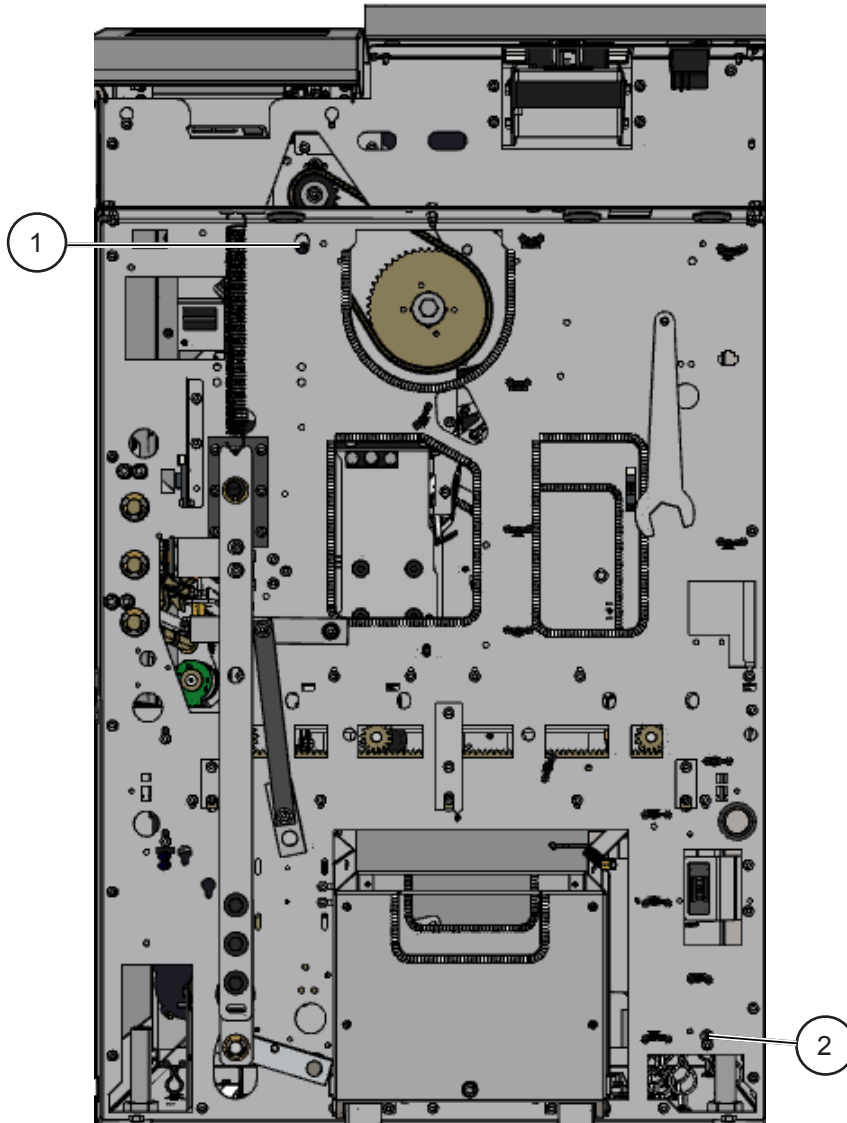

8. Secure Axis [G] in position [2].

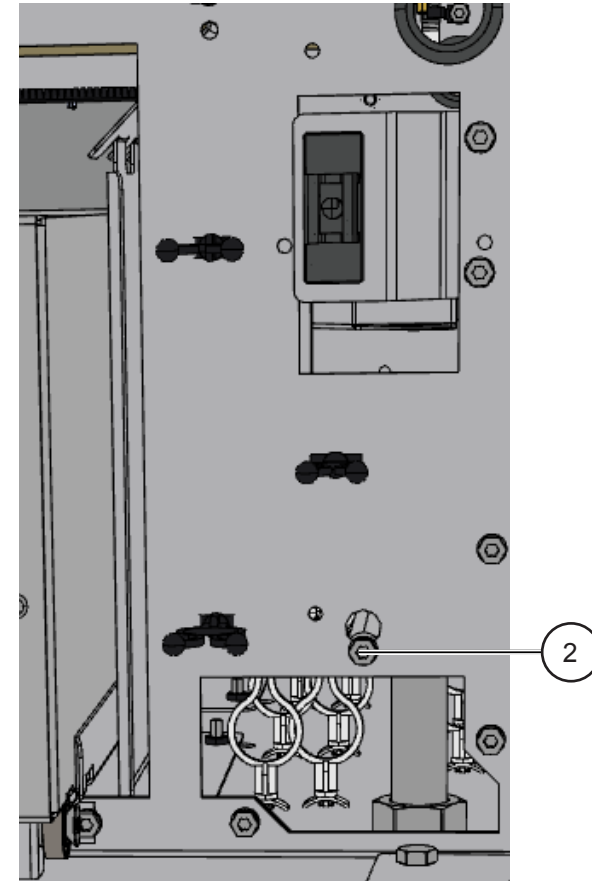

1.4.4 Trimmer security screws (continued)

9. Remove nut [H] that secures electrical panel.

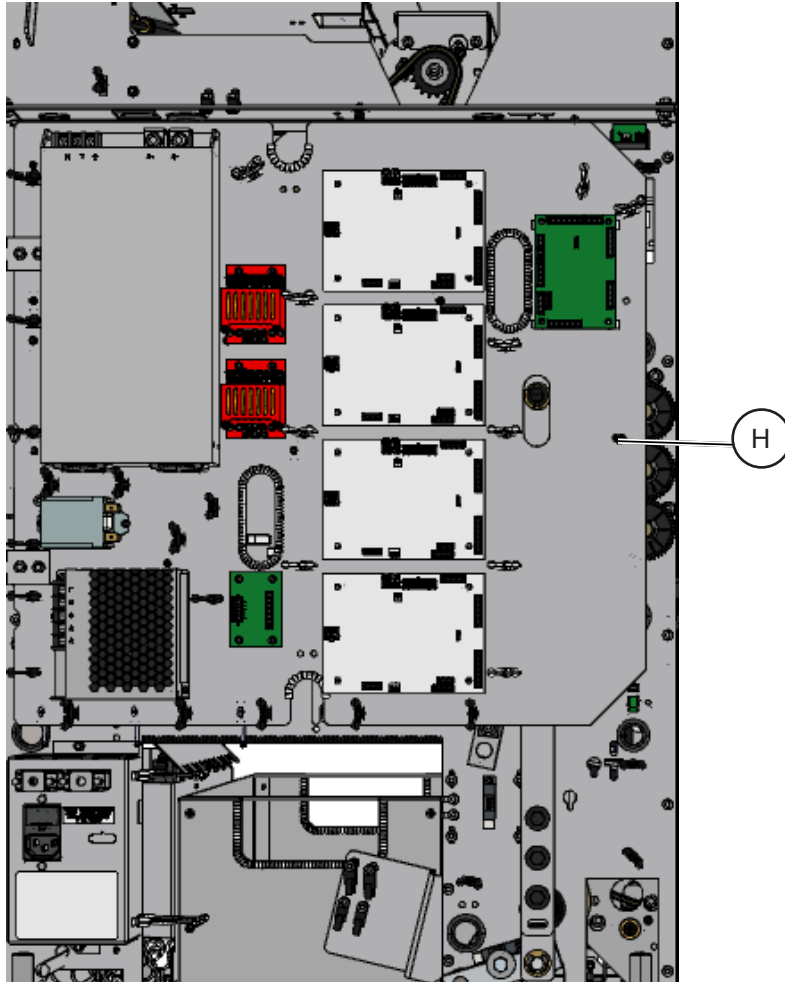

10. Remove securing Screw [I] (only requires keeping if machine will be shipped again).

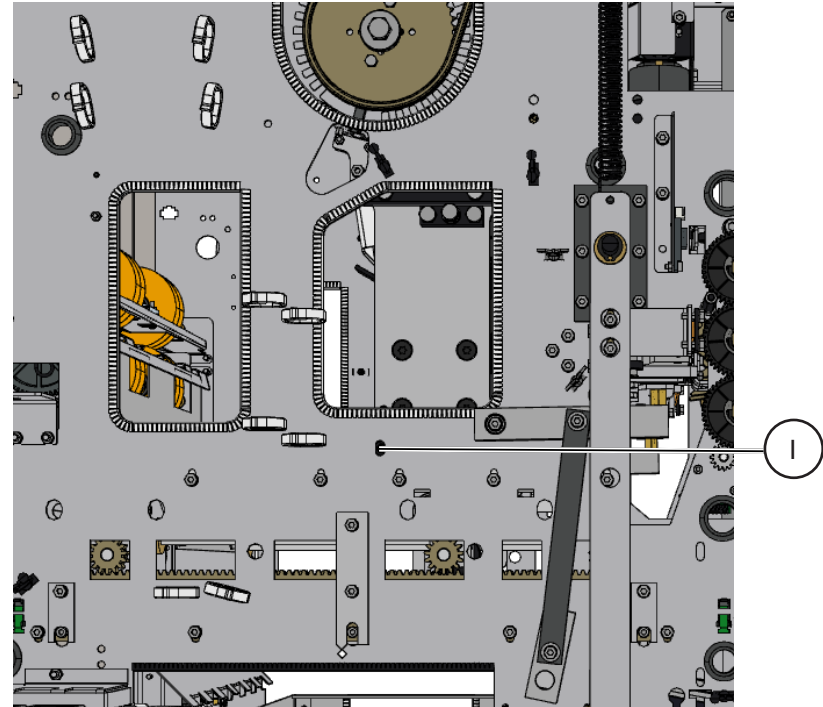

11. Replace electrical panel securing nut [H]. **NOTE!** Do not overtighten nut [H], as to do so will break the stud.
12. Replace covers.

1.4.5 Belt Stacker Installation

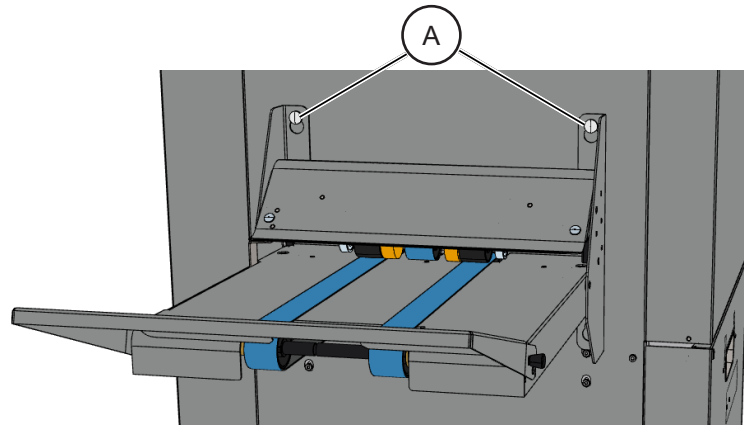

1. Hook the Belt Stacker to the studs [A] (2x) on the Main Module.

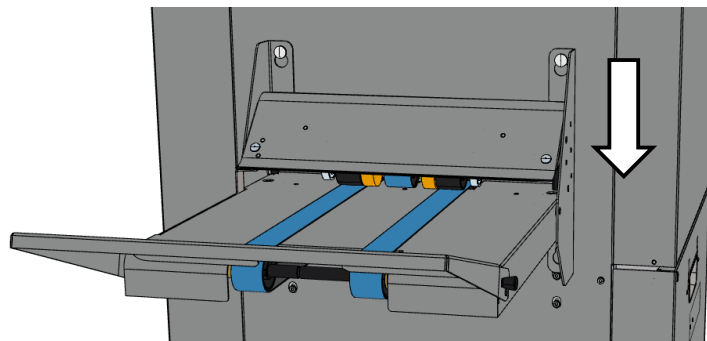

2. Let the Belt Stacker slide down in place.

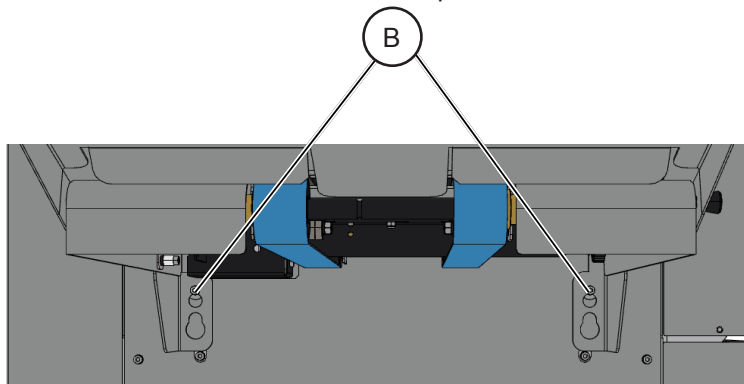

3. Secure the Belt Stacker with two screws [B].

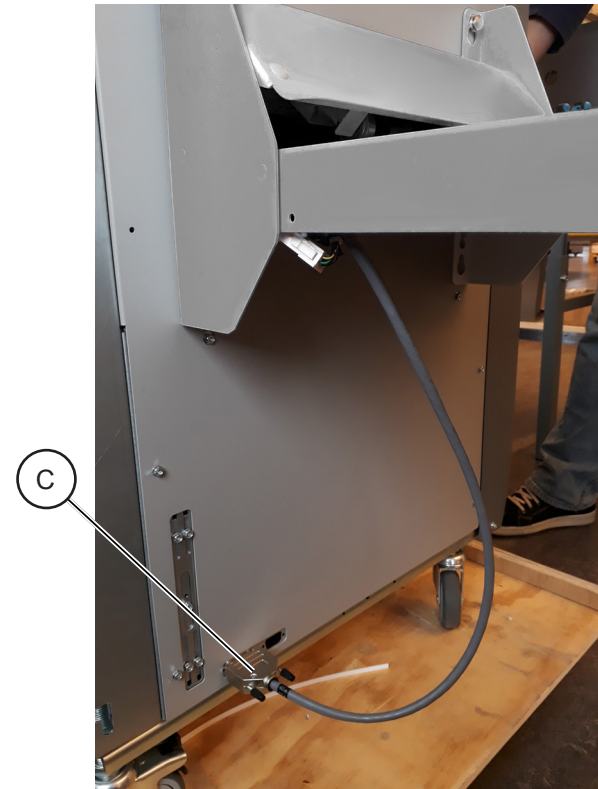

4. Connect the communication cable [C] to the Main Module.

1.4.6 Caster Locking Position

To prevent the Casters [A] from damaging or stopping the Front Waste Bin Cover [B] from opening they must be aligned as shown in the below image.

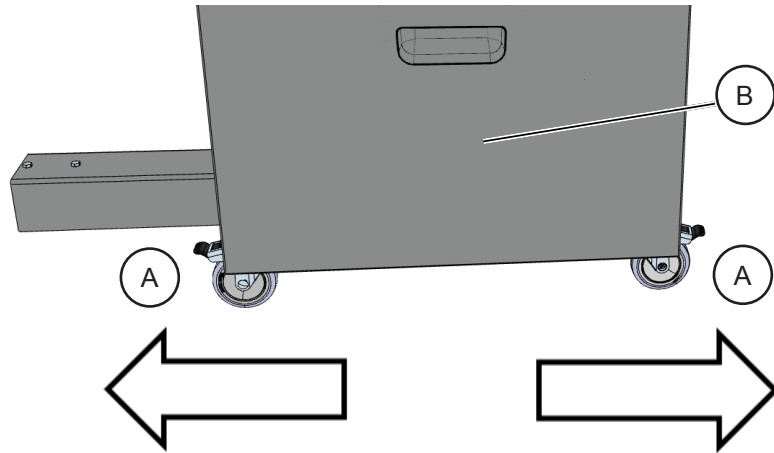

1.4.7 Earth Bonding

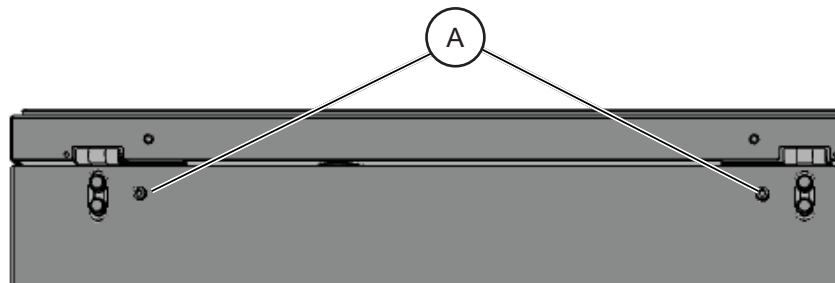

⚠ CAUTION:

The bare metal areas behind the screws [A] are for safety earth bonding between the Rear Cover and the machine chassis frame. Make sure you have good earth bonding between these areas, the screws and the chassis frame of the machine.

1.4.8 Plugging in the Machine

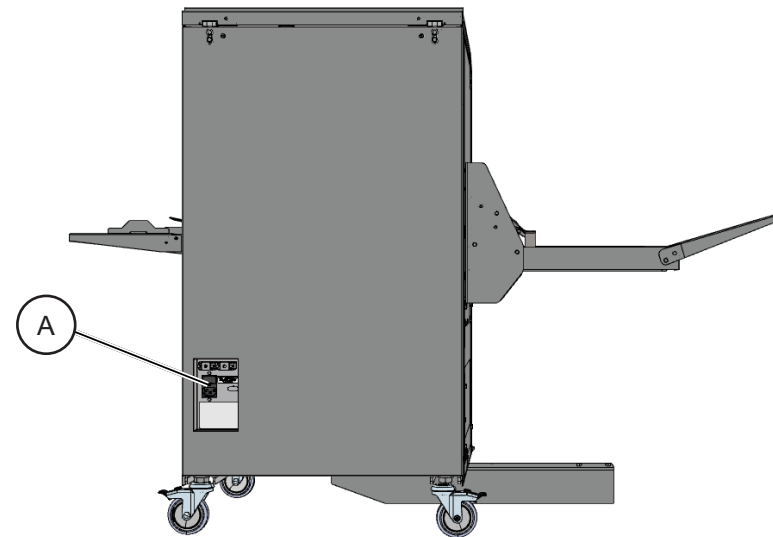

1. Plug in the machine with the provided power cable [A] that is stored in the Trim Waste Bin.